



Social Story

Today, I am going to LaunchPAD Children's Museum!



I could be going with my family, friends, or school!

When I first get to the museum, my grown up will check us in at **the front desk!**



I patiently wait next to my grown up while they get us checked in.

I can put my stuff in a **locker** or hang up my coat on the rack.



There is stroller parking here too!

There are **bathrooms** located at the front and back of the museum.



I can tell my grown up if I need to go to the bathroom before I start to play.

There are so many things to do at the museum!



Even though I am excited, I **walk** to each toy instead of run.

At the **Little LaunchTown**, I can pretend to be a mailman, construction worker, or doctor!



I can use bricks and boards to build a tower!

The **Stage** area is where I can dress up, control stage lights and sound, and see myself on TV!



I can borrow headphones from the museum if the sounds are too loud or borrow sunglasses from the museum if the lights are too bright.

I can pretend to make pizza or ice cream in **The Cafe** area.



If other kids are playing with the toys, I can ask to play with them. If they say “no”, it’s okay! I can wait until they are done.

I can use a cart to shop for groceries at the
Market.



Once I am done playing, I put the toys back where I
found them so other kids can play too!

At the **Water Table**, I can catch fish, build with legos, play with boats, and change the path of water!



There are aprons available if I don't want to accidentally get my clothes wet. When I am done, I can dry my hands with the hand dryer!

If I get thirsty, I can get a drink at the **water fountain**.



I can also buy food at **the concession stand**. I eat it at the tables so I don't get the rest of the museum messy.

At the **Wind Zone** I can make objects float and move with air!



The blowers can be loud! I might want to wear my headphones if this area is too loud for me.

At the **treehouse**, I can climb the stairs and go down the slide!



This is a good place to go when I need a calm area.

I can learn about farm animals and crops in the
Agriculture area.



There are other children that come to the museum to
play and have fun like me! We take turns playing with
the toys.

If I feel upset or overwhelmed, I can go to the
Sensory Room to calm down.



I ask the front desk for a key, and they will let
me in.

I can climb and explore **The Climber**.

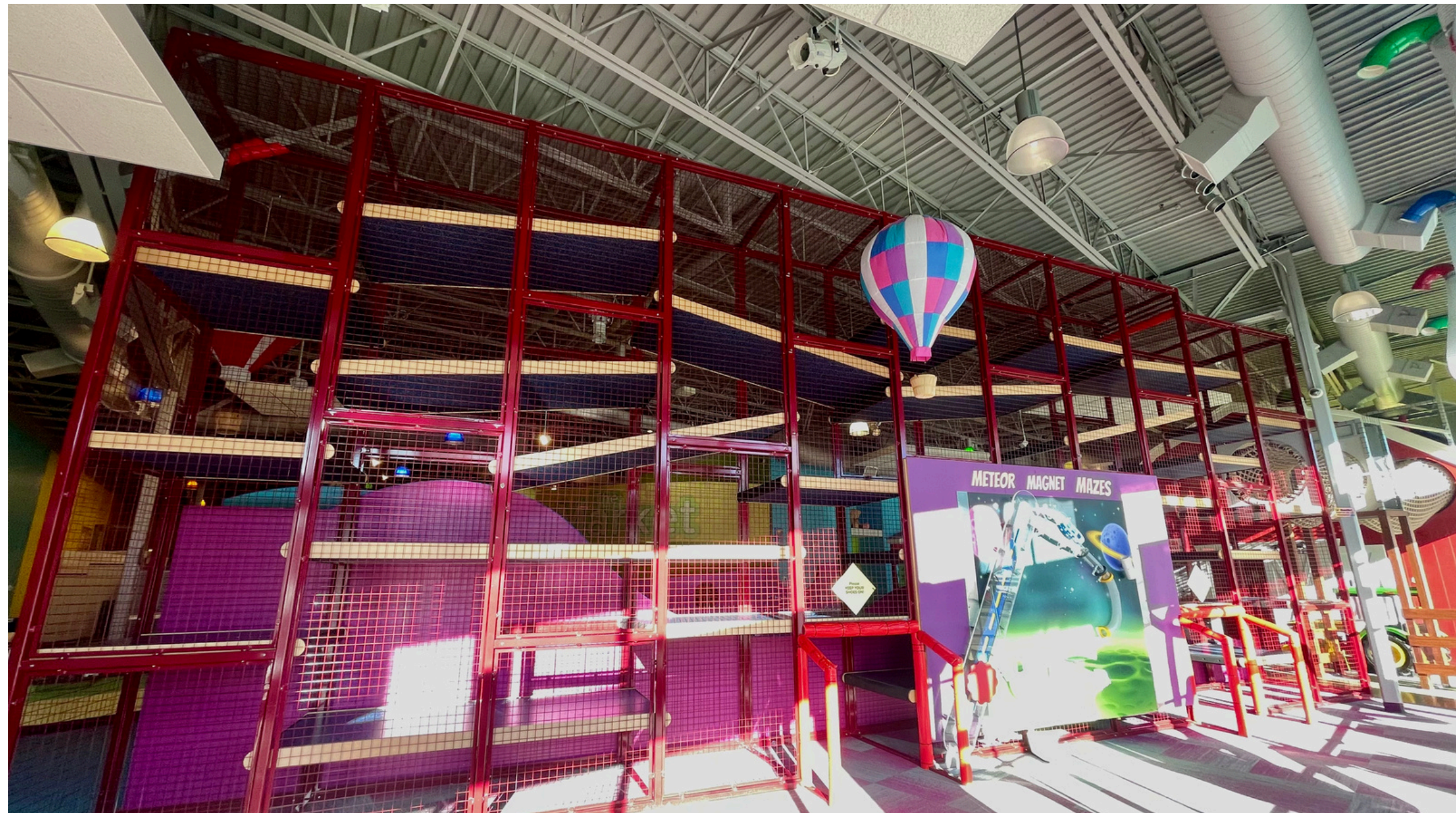

I am aware of my body when I am climb and pay attention to where other children are climbing too.

The **Infant and Toddler area** is a padded area where little ones can play.



This area is meant for kids under 3. If I am older than that, I can find another area to play!

The **Odyssey Toy Store** sells toys, stuffed animals, and T-Shirts.



At the end of the visit, I can ask my grown up to get me something. Sometimes they will say “yes”, sometimes they will say “no” and that’s okay!

**I had a great day at
LaunchPAD!**

